

BOX MINCE B32

WMG-B32



High-Power 5 HP Mincer for Superior Productivity!



HIGH POWER WITH A 5 HP MOTOR!

Increased motor capacity enables processing up to 600 kg of meat per hour!
Greatly improved productivity.

IMPROVED WORK EFFICIENCY!

The wider meat tray enhances work efficiency.

HYGENIC AND SAFE DESIGN

All main components — the cylinder, worm, plate ring, and meat tray - are made of stainless steel for easy cleaning and hygiene.

ONE-TOUCH DETACHABLE MECHANISM

Simply pull the lock lever to remove the cylinder easily. Cleaning and maintenance after use are smooth and effortless.

VARIETY OF PLATES AVAILABLE

A wide range of plates and knives are available to suit different grinding textures - from coarse to fine.

EXCELLENT FRESHNESS RETENSION

Our unique special roll design prevents meat from over-grinding, preserving its natural color, texture, and moisture for superior product quality.

Deflector (Option)



■DIMENSIONS

PLEASE CHECK APPROVED DRAWING FOR FURTHER DETAILS.

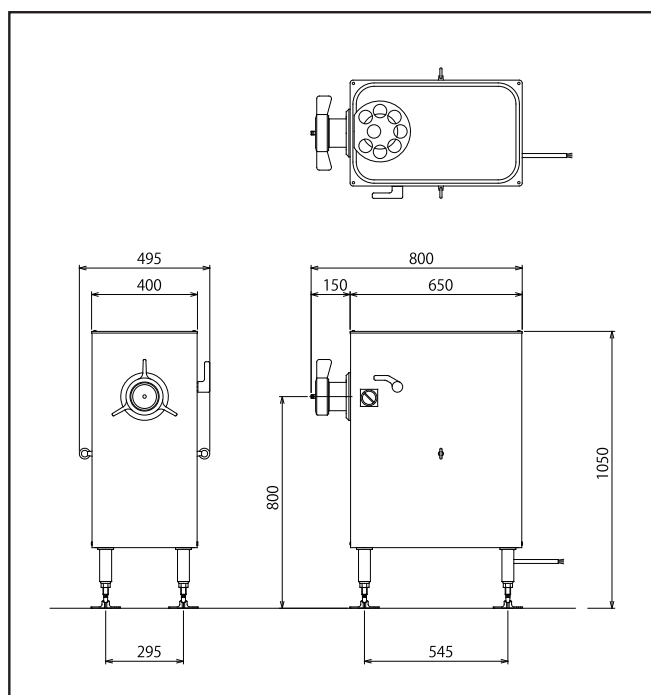

■SPECIFICATIONS

DIMENSIONS	W495*L800*H1,050mm
WEIGHT	145kg
PROCESSABLE DIMENSIONS	Circular: R25mm, Rectangular: W35mm
CAPACITY	Max 600kg/hr
SLICE TEMPERATURE	-4°C~0°C(Depends on product)
RATED ELECTRIC CAPACITY	OUTPUT 3.7kW CURRENT 15.8A (50/60Hz w/o load)
POWER CONSUMPTION	750W/650W (50/60Hz w/o load)
POWER SUPPLY	3Phase 200V 50/60Hz More than 30A

WATANABE
WATANABE FOODMACH CO.,LTD.

2-12-26 TSUYUHASHI NAKAGAWA-KU NAGOYA JAPAN
TEL052-361-8511 FAX052-361-8490
URL : <https://www.foodmach.co.jp/>

SALES AGENT